



LEGEND

- Parking Bay - Time Limited Parking
- Parking Bay - Short Stay
- Parking Bay - Permit Holders Only
- Parking Bay - Permit Holders and Time limited parking
- Parking Bay - Solo Motor/Cycle
- Parking Bay - Loading Only
- Parking Bay - Electric Vehicle
- Parking Bay - Disabled
- Bus Stand
- Proposed Yellow Road Marking
- Proposed Segregated Two-way Cycle Lane

NOTES

- All double yellow lines within Controlled Parking Zones to be realigned to allow for new kerblines/crossings etc.

SAFETY, HEALTH AND ENVIRONMENTAL INFORMATION

In addition to the normal hazards and risks associated with the type of work detailed on this drawing, the following significant hazards have been identified by the designer. No unusual hazards or risks.

Further information on these hazards can be found in the designer risk management and preconstruction information documentation.

Rev	Date	Description	Drn	Chk	App
1	15/12/25	RESTRICTIONS AMENDED	GS	DP	DP
0	17/10/25	FIRST ISSUE	GS	ID	DP

PROJECT CENTRE

www.marstonholdings.co.uk/projectcentre

Client: Brighton & Hove City Council

Project: **A259 CYCLE LANE**

Drawing Title: **TRAFFIC REGULATION ORDER SHEET 13 OF 16**

Drawing Status: **STAGE 4**

Drawn	Designed	Date	Scale	Size
IC	DP	JULY 25	1:250	A1

Drawing No. 1000010802-1220-13 Rev 1

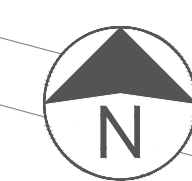

LEGEND

	Parking Bay - Time Limited Parking
	Parking Bay - Short Stay
	Parking Bay - Permit Holders Only
	Parking Bay - Permit Holders and Time limited parking
	Parking Bay - Solo Motor/Cycle
	Parking Bay - Loading Only
	Parking Bay - Electric Vehicle
	Parking Bay - Disabled
	Bus Stand
	Proposed Yellow Road Marking
	Proposed Segregated Two-way Cycle Lane

NOTES

- All double yellow lines within Controlled Parking Zones to be realigned to allow for new kerblines/crossings etc.

SAFETY, HEALTH AND ENVIRONMENTAL INFORMATION
 In addition to the normal hazards and risks associated with the type of work detailed on this drawing, the following significant hazards have been identified by the designer.
 No unusual hazards or risks.

Further information on these hazards can be found in the designer risk management and preconstruction information documentation.

Hazard location & ID

Rev	Date	Description	Drn	Chk	App
2	07/01/26	TRO TEXTS AMENDED	GS	DP	DP
1	15/12/25	RESTRICTIONS AMENDED	GS	DP	DP
0	17/10/25	FIRST ISSUE	GS	ID	DP

This drawing has been specifically prepared to meet the requirements of the named client and may contain design and innovative features which differ from conventional design standards.



Client	
Project	A259 CYCLE LANE
Drawing Title	TRAFFIC REGULATION ORDER SHEET 14 OF 16
Drawing Status	STAGE 4
Drawn	IC
Designed	DP
Date	JULY 25
Scale	1:250
Size	A1
Drawing No.	1000010802-1220-14
Rev	2

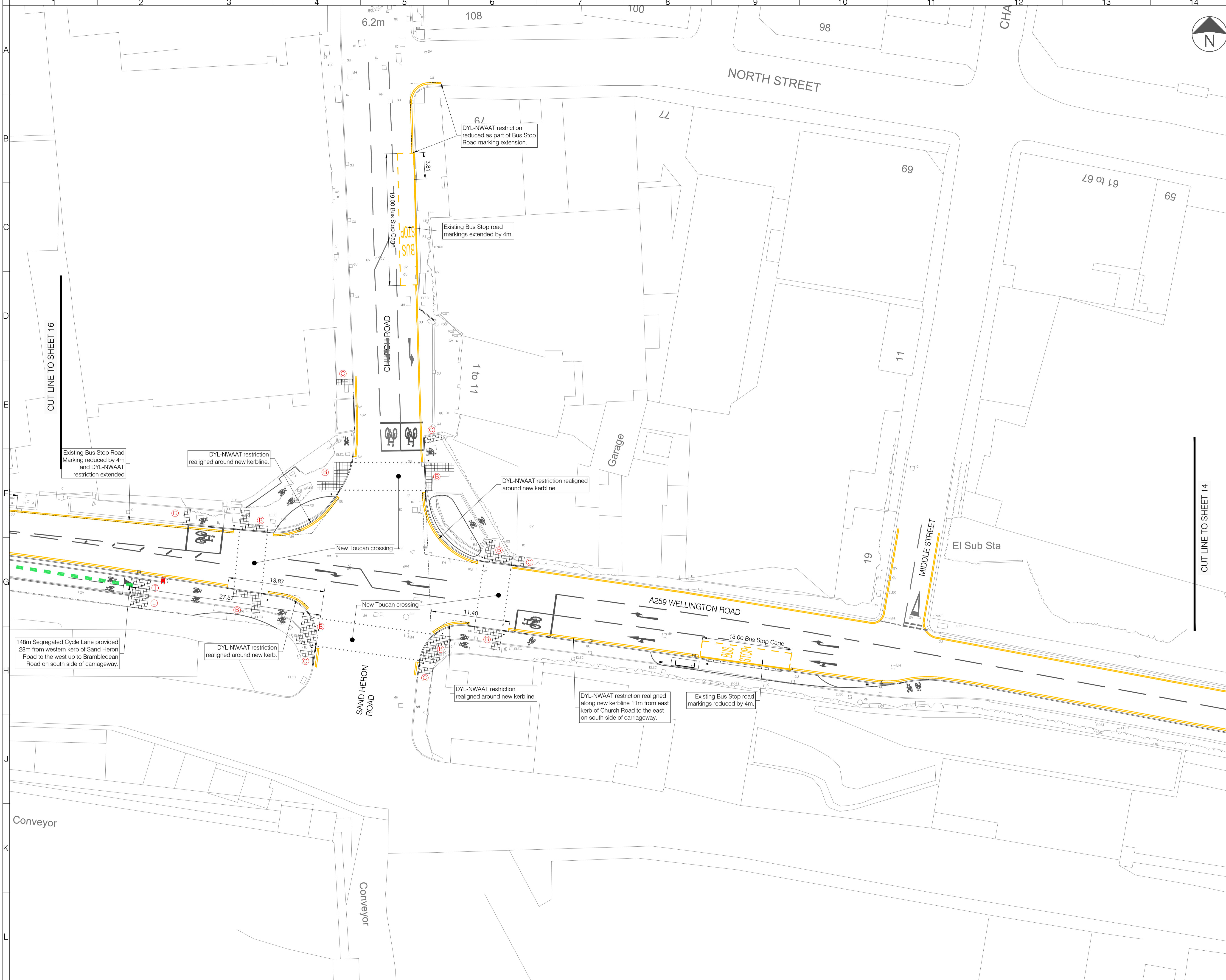

LEGEND

- Parking Bay - Time Limited Parking
- Parking Bay - Short Stay
- Parking Bay - Permit Holders Only
- Parking Bay - Permit Holders and Time limited parking
- Parking Bay - Solo Motor/Cycle
- Parking Bay - Loading Only
- Parking Bay - Electric Vehicle
- Parking Bay - Disabled
- Bus Stand
- Proposed Yellow Road Marking
- Proposed Segregated Two-way Cycle Lane

NOTES

1. All double yellow lines within Controlled Parking Zones to be realigned to allow for new kerblines/crossings etc.

SAFETY, HEALTH AND ENVIRONMENTAL INFORMATION
 In addition to the normal hazards and risks associated with the type of work detailed on this drawing, the following significant hazards have been identified by the designer.
 No unusual hazards or risks.
 Further information on these hazards can be found in the designer risk management and preconstruction information documentation.

Rev	Date	Description	Drn	Chk	App
2	07/01/26	TRO TEXTS AMENDED	GS	DP	DP
1	15/12/25	RESTRICTIONS AMENDED	GS	DP	DP
0	17/10/25	FIRST ISSUE	GS	ID	DP



Client					
Project A259 CYCLE LANE					
Drawing Title TRAFFIC REGULATION ORDER SHEET 15 OF 16					
Drawing Status STAGE 4					
Drawn	Designed	Date	Scale	Size	
IC	DP	JULY 25	1:250	A1	
Drawing No. 1000010802-1220-15					Rev 2

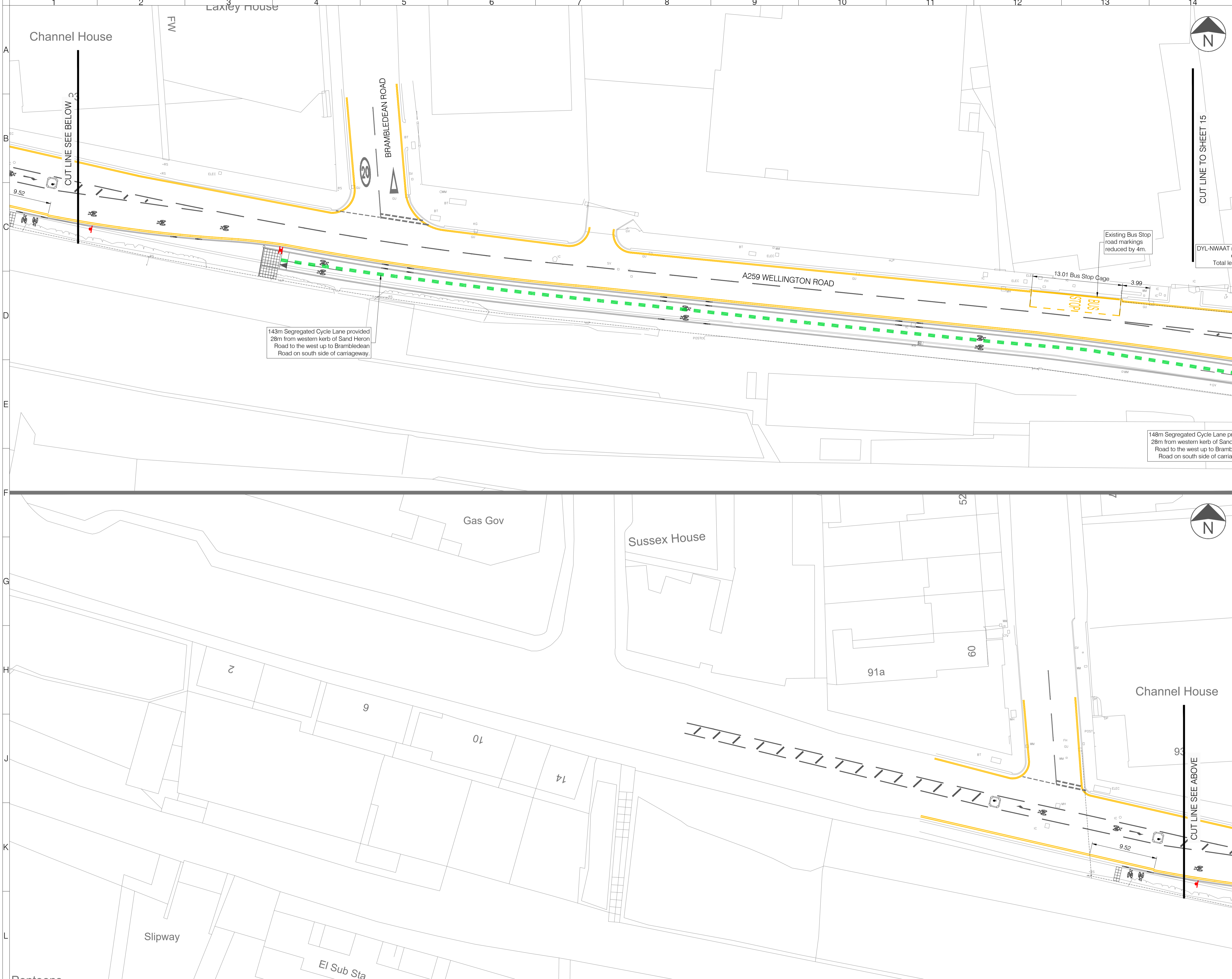

143m Segregated Cycle Lane provided 28m from western kerb of Sand Heron Road to the west up to Brambledean Road on south side of carriageway.

148m Segregated Cycle Lane provided 28m from western kerb of Sand Heron Road to the west up to Brambledean Road on south side of carriageway.

Existing Bus Stop road markings reduced by 4m.

- LEGEND**
- Parking Bay - Time Limited Parking
 - Parking Bay - Short Stay
 - Parking Bay - Permit Holders Only
 - Parking Bay - Permit Holders and Time limited parking
 - Parking Bay - Solo Motor/Cycle
 - Parking Bay - Loading Only
 - Parking Bay - Electric Vehicle
 - Parking Bay - Disabled
 - Bus Stand
 - Proposed Yellow Road Marking
 - Proposed Segregated Two-way Cycle Lane

NOTES

- All double yellow lines within Controlled Parking Zones to be realigned to allow for new kerblines/crossings etc.

SAFETY, HEALTH AND ENVIRONMENTAL INFORMATION

In addition to the normal hazards and risks associated with the type of work detailed on this drawing, the following significant hazards have been identified by the designer.

No unusual hazards or risks.

Further information on these hazards can be found in the designer risk management and preconstruction information documentation.

Rev	Date	Description	Drn	Chk	App
1	15/12/25	RESTRICTIONS AMENDED	GS	DP	DP
0	17/10/25	FIRST ISSUE	GS	ID	DP



Client: Brighton & Hove City Council

Project: A259 CYCLE LANE

Drawing Title: TRAFFIC REGULATION ORDER SHEET 16 OF 16

Drawing Status: STAGE 4

Drawn	Designed	Date	Scale	Size
IC	DP	JULY 25	1:250	A1

Drawing No. 1000010802-1220-16

Rev 1