

- This drawing is to be read in conjunction with all other Bright Plan Civils drawings, and with all relevant Architect's and Engineer's drawings and specification. Any discrepancies found are to be reported immediately to the Engineer.
- Bright Plan Civils accepts no responsibility for inaccuracies in data provided by third parties such as topographic surveys or Ordnance Survey mapping.
- Do not scale; work to figured dimensions only. All dimensions are in millimeters unless noted otherwise and all levels are in metres from the topographic survey datum.
- Any information given regarding existing underground services is given in good faith after consultation with the relevant authority, however accuracy is not certain. The main contractor is responsible for checking all information on site prior to work commencing and taking due care whilst undertaking the works.
- All dimensions to be checked on site. All details and dimensions relating to sub-contractors work must be checked and agreed between the sub-contractor or supplier and the general contractor.
- The electronic information from this drawing can not be guaranteed as dimensionally drawn exact. Figured dimensions must be used for setting out and detailing. Bright Plan Civils logos and company information must be removed from copies if information is re-used.

RESIDUAL HAZARDS

- In addition to the hazards/risks normally associated with the type of work detailed on this drawing, note the following:
- Buried services. Contractor to refer to record drawings and use CAT to locate existing services and undertake necessary precautions and investigation prior to excavating.
 - Working in live traffic. Contractor to ensure traffic management is designed, erected and maintained to protect the workforce and the public. Contractor to undertake necessary precautions and ensure suitable traffic management is in place prior to commencement.
 - Working in live sewers. Contractor to ensure operatives are familiar and competent with the dangers of working in live sewers.
 - Excavations close to existing structures. Contractor to prepare method statement to ensure stability of existing structure.
- It is assumed that all works will be carried out by a competent contractor working, where appropriate, to an approved risk assessment and method statement.

This map is based on or reproduced from Ordnance Survey material with the permission of Ordnance Survey on behalf of the controller of Her Majesty's Stationary Office (c) Crown Copyright. This drawing is based upon Ordnance Survey mapping - BPC accept no liability for any inaccuracies with the data. (c) Crown Copyright 2018. All rights reserved. Licence number 10002432

A	Revised Issue	06/09/2023
-	Original Issue	11/07/2023
Rev.	Amendments	Date



BRIGHT PLAN CIVILS
Transport Planning and Infrastructure Design Consultants
2 West Barn, Norlton Lane, Chichester, West Sussex PO20 3AF
Tel: 01243 308 3046
www.bpcivils.co.uk enquiries@bpcivils.co.uk

Drawing Status	FOR APPROVAL		
Client	Tate Bros Ltd		
Project	Mayberry Garden Centre		
Drawing Title	BHCC Existing and Proposed Bus Stop & Disabled Bay		
Scale	1:200	Date	23 Sep
Drawn By	DJL	Checked By	MJA
Drawing No.	D2099-217	Rev.	A

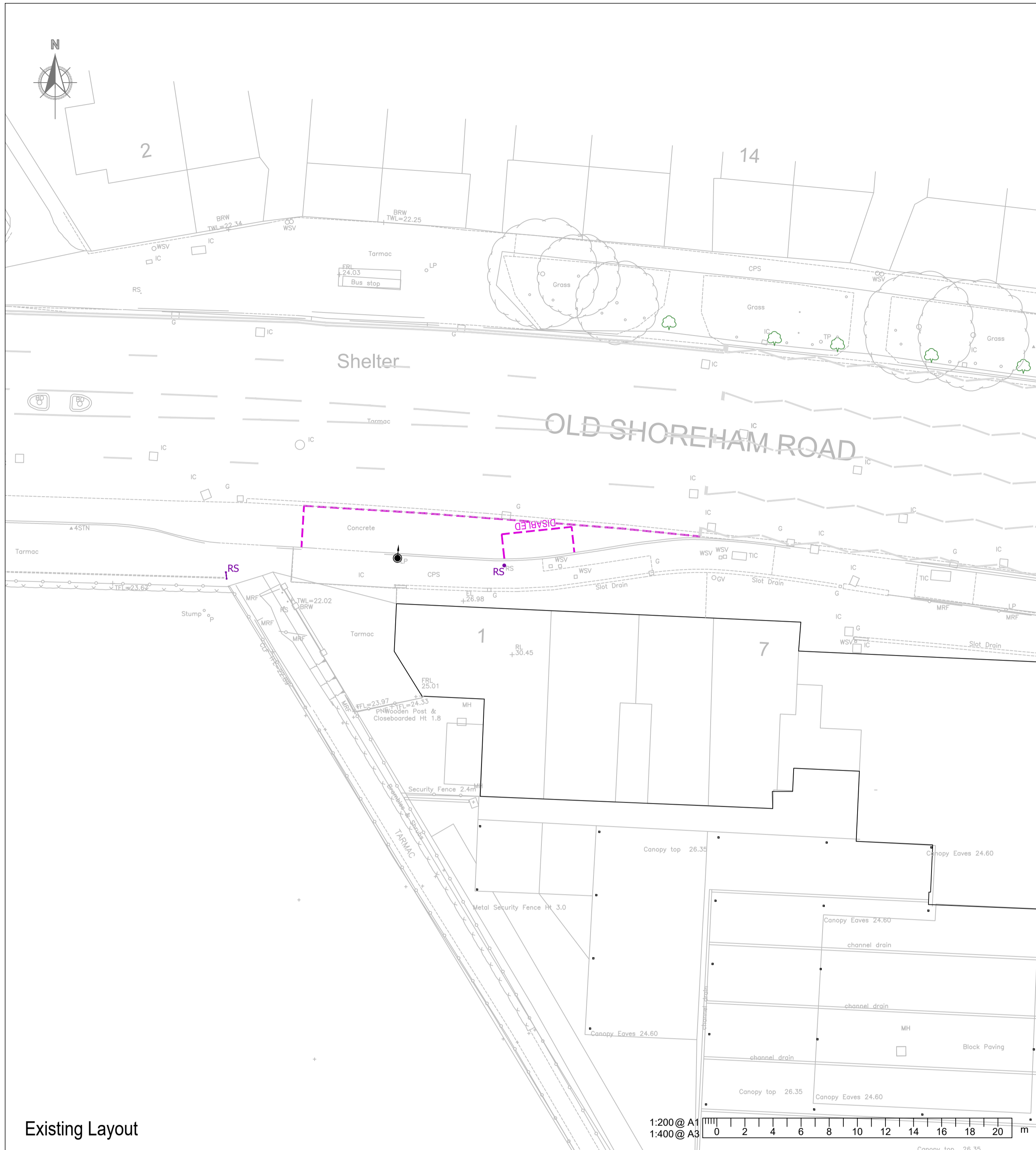

Existing Layout

1:200 @ A1
1:400 @ A3

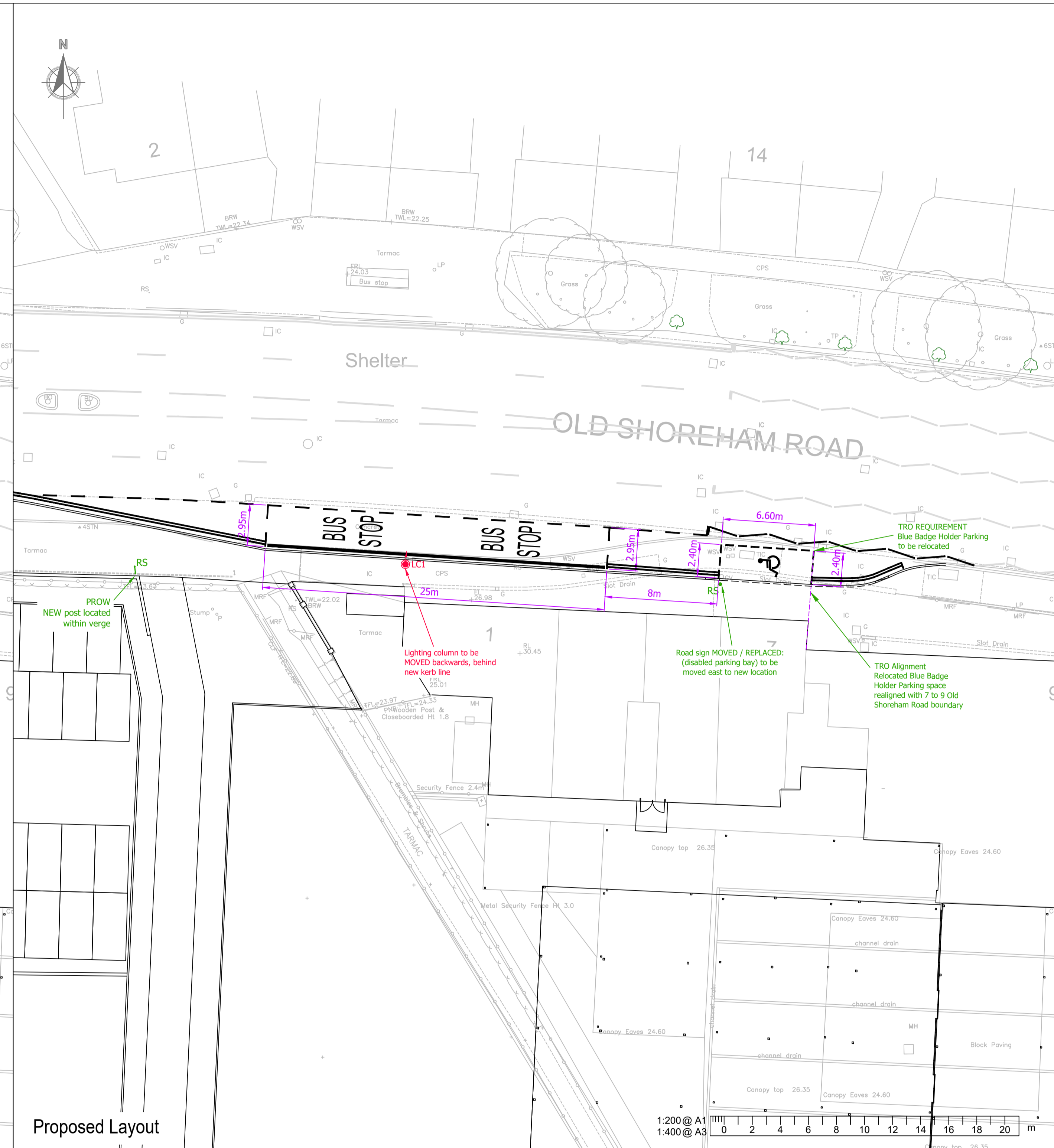

Proposed Layout

1:200 @ A1
1:400 @ A3

FOR APPROVAL

-ROAD MARKINGS KEY-

	Existing Road Marking TO BE RETAINED
	Existing Road Marking TO BE REMOVED
	Existing Waiting Restrictions REFRESHED
	Proposed Road Marking (TSRGD 2016)

-SIGNAGE KEY-

	Existing Road Sign/Traffic Sign
	Proposed Road Sign
	Existing Bollard/Sign Face
	Proposed Bollard/Sign Face
	Street Lighting (Existing)
	Street Lighting (Proposed) (Refer to 3rd Party Design)

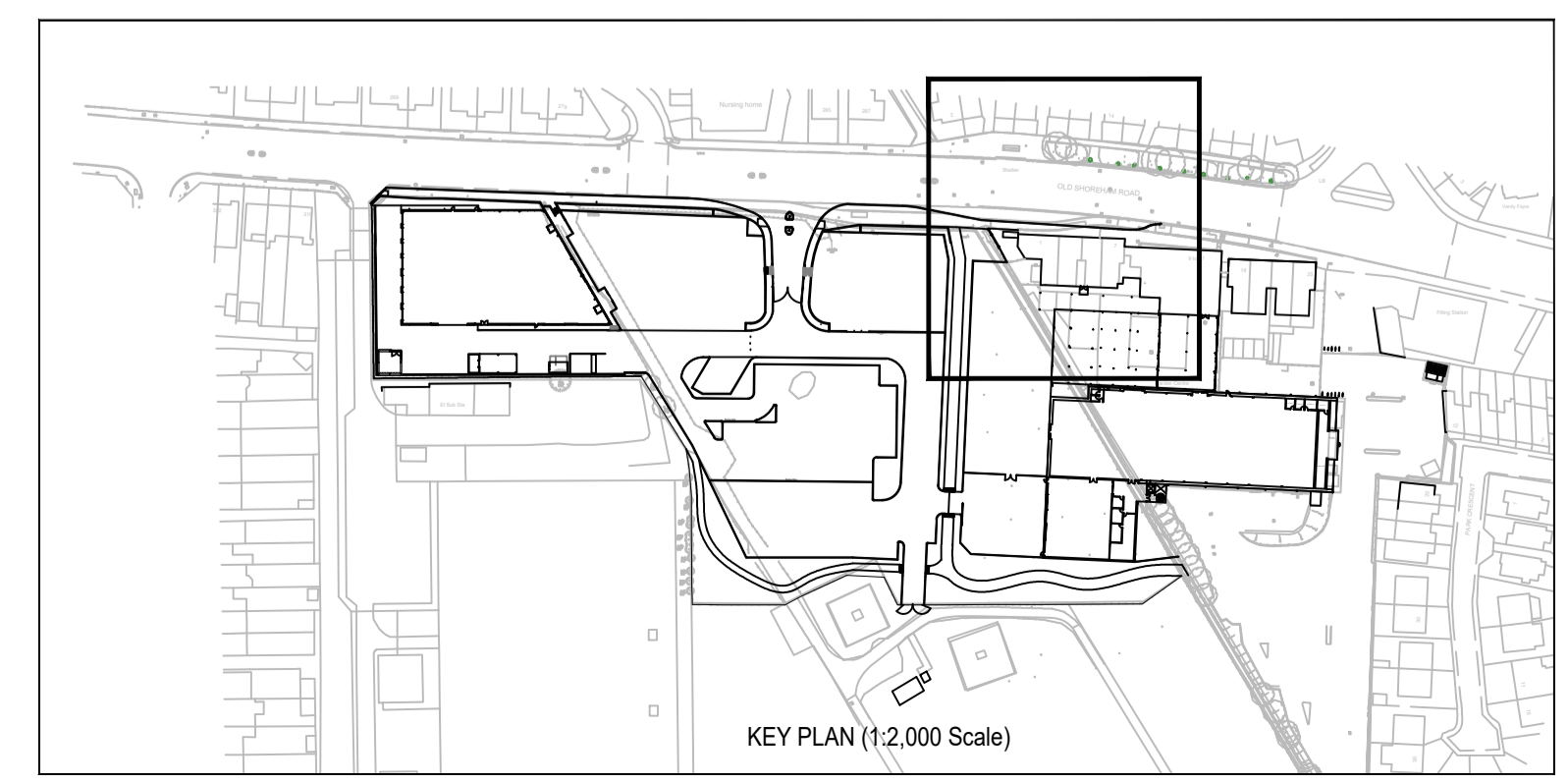

KEY PLAN (1:2,000 Scale)