

Brighton & Hove City Council (EC715.415 Benfield Valley)

Submission to Secretary of State

Document 17

Completed health and safety at the site questionnaire

Health and safety at the site questionnaire

The Inspector will visit the site and will need to know what safety equipment and protective clothing to bring. The following questions indicate the type of information the Inspector will need about the site. Please supply any additional information on a separate sheet of paper.

1. Is the site uneven or does it present any other known risks? Is special footwear or any other Personal Protection Equipment required?

Uneven ground – would recommend walking boots with ankle support

2. Is there any likelihood of exposure to pets or other animals which may present a risk to the safety of the Inspector?

Dog walkers

3. Is the site remote and/or can it be seen from other highways or rights of way?

The site can be accessed from the road – Meads Avenue (road parking), or
Hangleton Lane (car park)

4. Does the site have a good mobile phone signal or is there easy access to a public telephone should the emergency services be required?

Good mobile phone signal

5. Is the right of way easily accessible? Will arrangements for access by the Inspector need to be made in advance?

The paths have become overgrown on eastern side since the dispute started (points A and B on the map below). However, they can be seen from the footpath running up through Benfield Footgolf, to the west of the paths – FP H8a (from point D on the map below)

See map below

6. Are there any dangerous pieces of equipment or substances stored at any point along the right of way?

No

7. If there is any other relevant information which the Inspector should be aware of that is not covered in this questionnaire?

This is a footgolf site so there may be people playing – be aware of footballs being kicked to the side of Footpath FP H8a

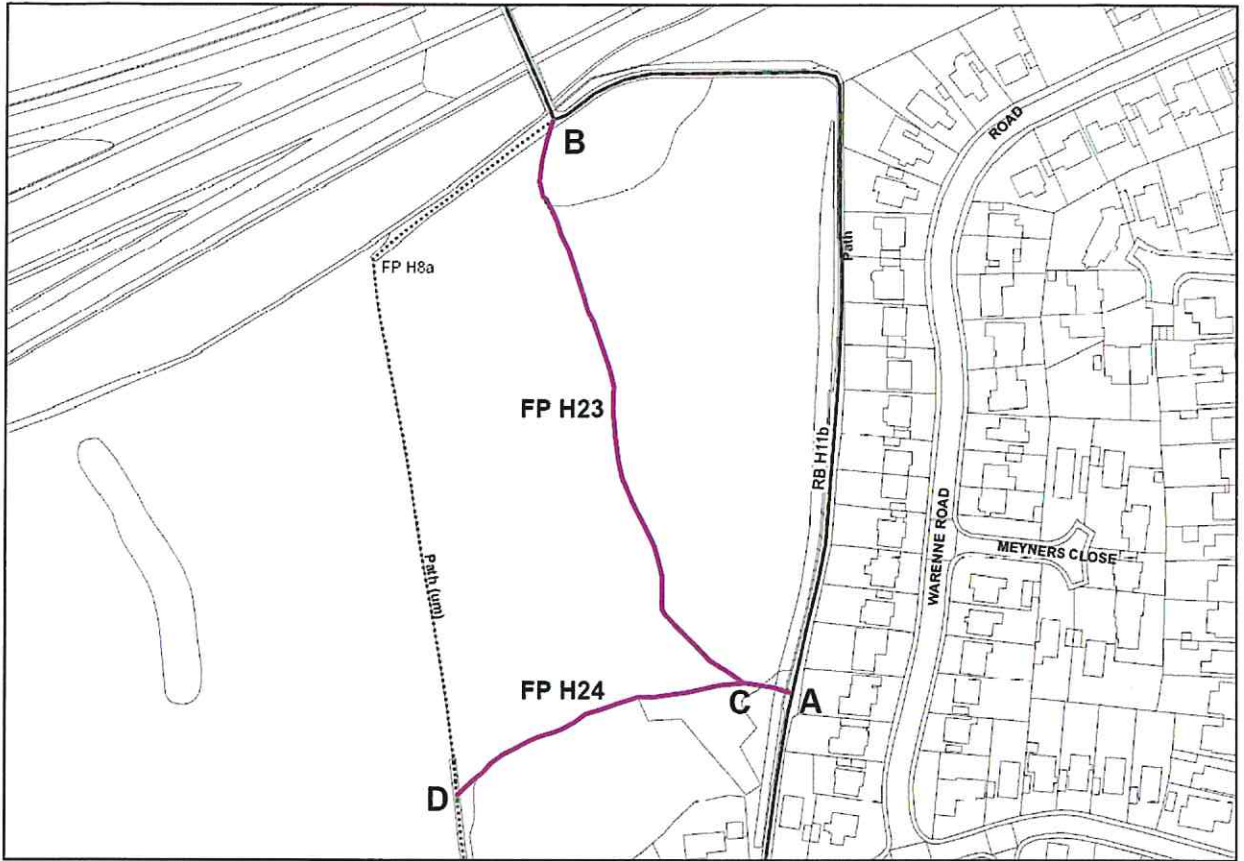

Benfield Valley, Map for DMMO Applications
For new Footpaths (FP H23 & FP H24)

1:1,510



Reproduced from the Ordnance Survey mapping with permission of the Controller of Her Majesty's Stationery Office. © Crown Copyright. Unauthorised reproduction infringes Crown Copyright and may lead to prosecution or Civil Proceedings. Brighton & Hove City Council
10/0000 1/10/2016

