

- LEGEND:**
- TAKE UP AND SET ASIDE GRANITE KERB TO REUSE FOR NEW BUILDOUT
 - TO BE REMOVED
 - ROAD MARKINGS TO BE REMOVED
 - EXISTING PAVING SLABS TO BE REMOVED
 - EXISTING ASPHALT TO BE REMOVED

REV	DATE	BY	REVISION DETAILS	CHK	APP
A	08/07/22	PS	INITIAL RELEASE	BS	-

PROJECT: BHCC SAFER SCHOOL STREETS PHASE 1

TITLE: QUEENS PARK PRIMARY SCHOOL FRESHFIELD PLACE, BRIGHTON SITE CLEARANCE

DRAWING STATUS: DESIGN







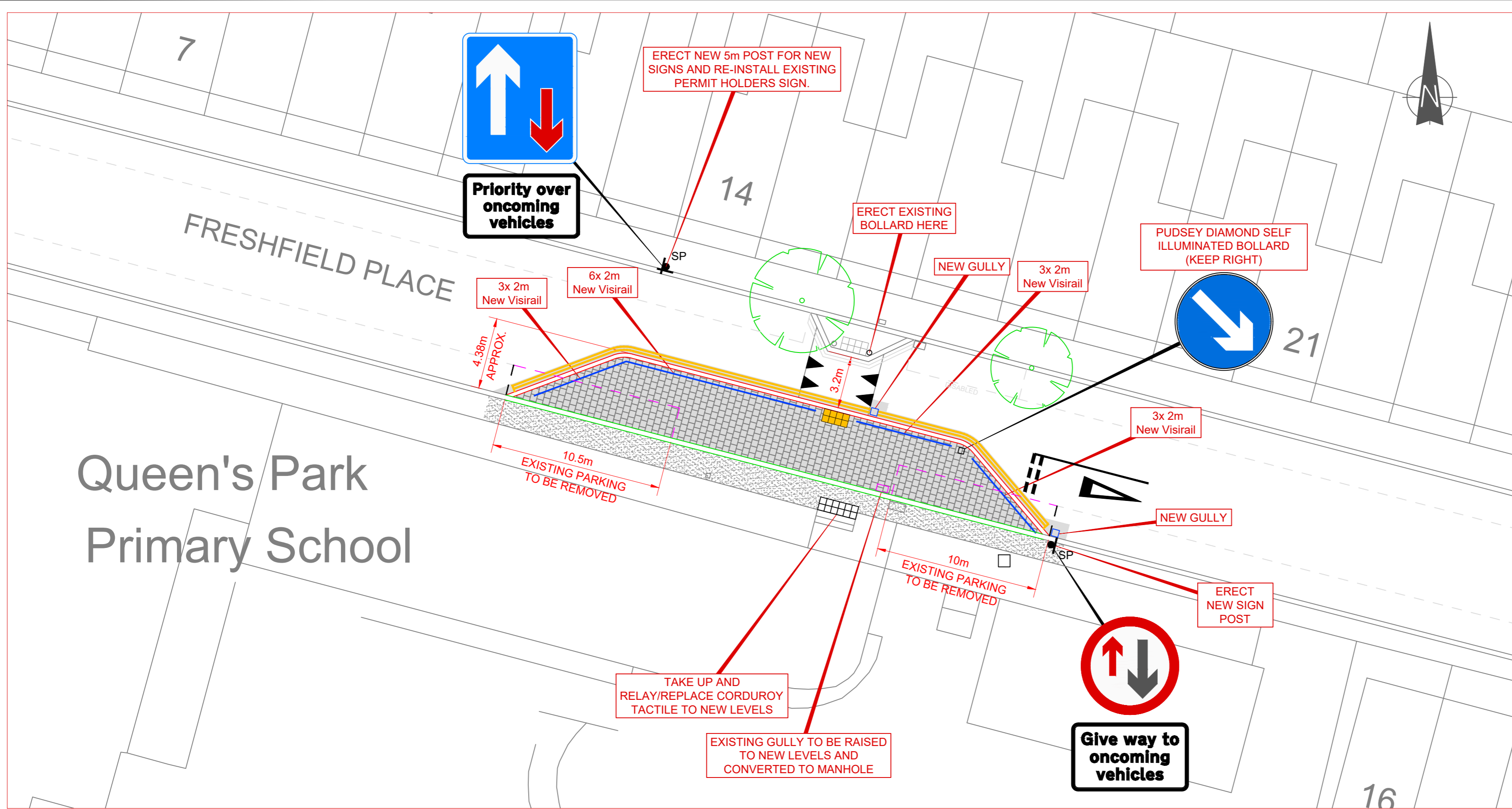



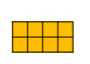

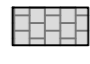
DRAWN: PS	SURVEYED: PS	CHECKED: BS	APPROVED: -
-----------	--------------	-------------	-------------

DRAWING No: Queens Park Primary.dwg

DATE: JULY 2022	SCALE: 1:200	SIZE: A2	REV: A
-----------------	--------------	----------	--------

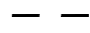

LEGEND:

-  NEW 2m VISIRAIL
-  400 x 400mm TACTILE PAVING (BUFF COLOUR)
-  NEW GULLY
-  NEW FOOTWAY BUILDOUT - PAVING SLABS TO MATCH EXISTING
-  CARRAIGWAY REPAIR
-  FOOTWAY REPAIR
-  REUSED 300mm GRANITE KERB
-  NEW CS2 CHANNEL KERBS
-  NEW SIGN POST
-  TSRGD DIAG 1018.1
-  TSRGD DIAG 1028.4
-  TSRGD DIAG 1003A
-  TSRGD DIAG 1062
-  TSRGD DIAG 1023A

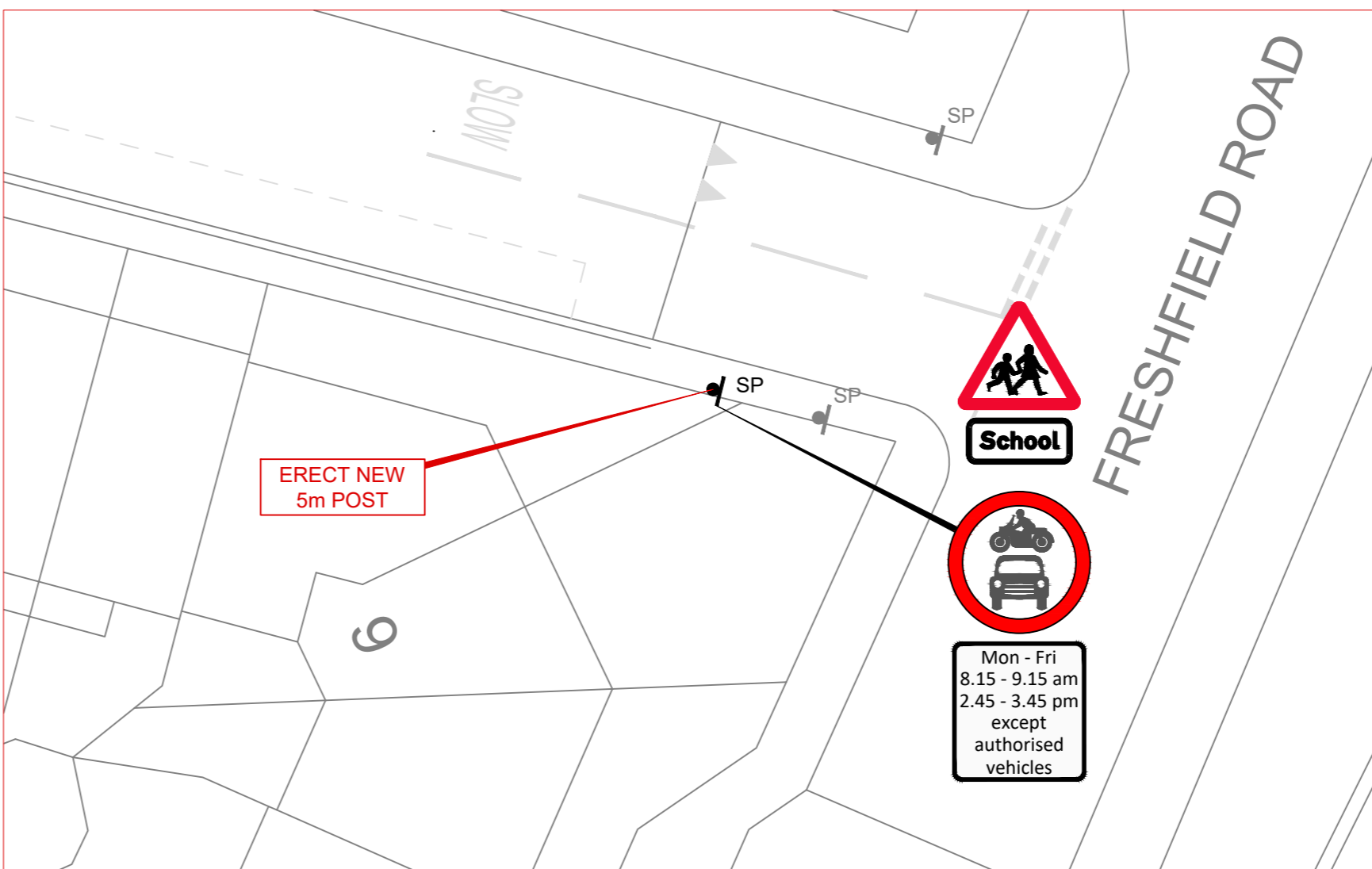
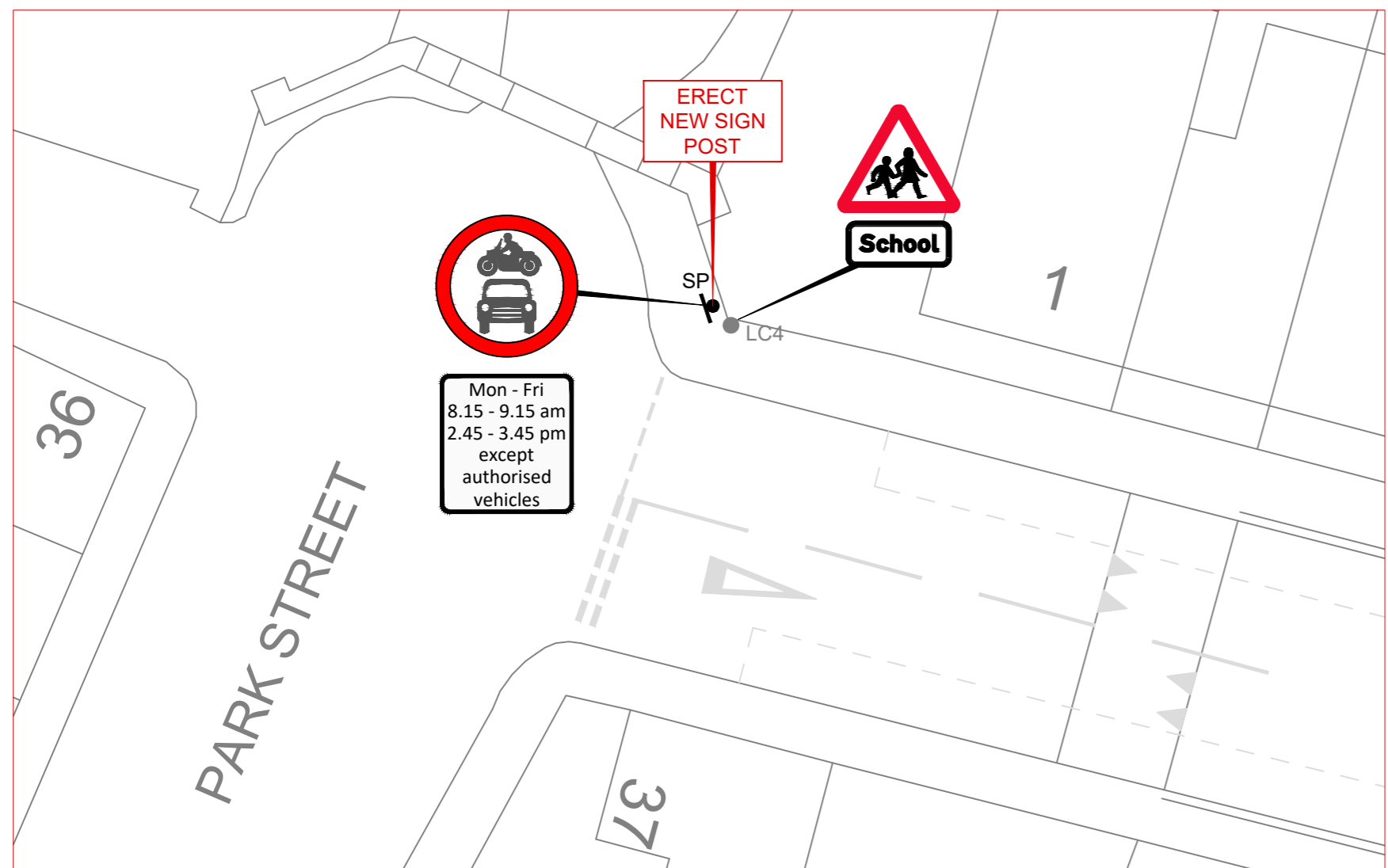

REV	DATE	BY	REVISION DETAILS	CHK	APP
A	08/07/22	PS	INITIAL RELEASE	BS	-

Brighton & Hove City Council

PROJECT: BHCC SAFER SCHOOL STREETS PHASE 1

TITLE: QUEENS PARK PRIMARY SCHOOL FRESHFIELD PLACE, BRIGHTON

DRAWING STATUS: DESIGN

DRAWN: PS	SURVEYED: PS	CHECKED: BS	APPROVED:
-----------	--------------	-------------	-----------

DRAWING No: Queens Park Primary.dwg

DATE: JULY 2022	SCALE: 1:200	SIZE: A2	REV: A
-----------------	--------------	----------	--------