

BASEMENT PLAN

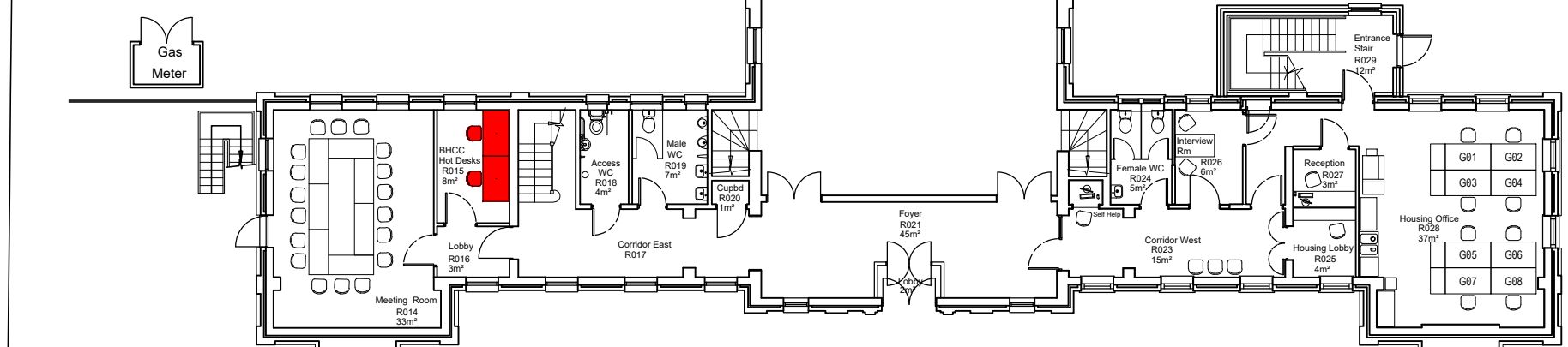

GROUND FLOOR PLAN - 495m²

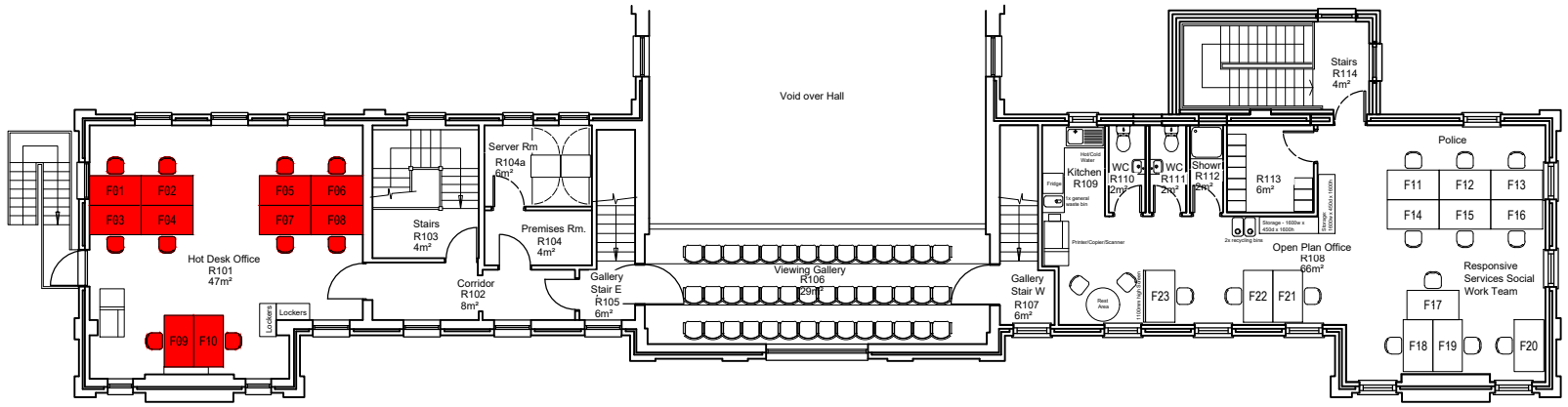

FIRST FLOOR PLAN - 205m²

REV	DATE	DESCRIPTION

Drawing Status
FOR INFORMATION



BRIGHTON & HOVE CITY COUNCIL
PROPERTY & DESIGN
KINGS HOUSE, GRAND AVENUE,
HOVE, EAST SUSSEX, BN3 2LS
Telephone: (01273) 290000 Fax No. (01273) 291467

Project
Brighton & Hove City Council

Title
Portslade Town Hall

Drawn By: MS Checked: Date: May 2022

Project No.: **GEN 000** Scale: 1:200 @ A3

Drawing No.: **PTH01** Revision: -

This drawing should be read in conjunction with all other drawings. Do not scale. All Dimensions must be site checked. Copyright © Brighton & Hove City Council.